

DATE: Nov 01, 2010 - 3:12PM
FILENAME: L:\1166 Mill Pond\002 Concept\1166-CONCEPT 02.dwg
DRAWN BY: ELU
CHECKED BY: JCB
DESIGNED BY: ELU
APPROVED BY: JCB

Copyright © ESS Group, Inc., 2010



EXISTING ACCESS TO MILL POND



PROPOSED LOCATION OF CRUSHED STONE PATH

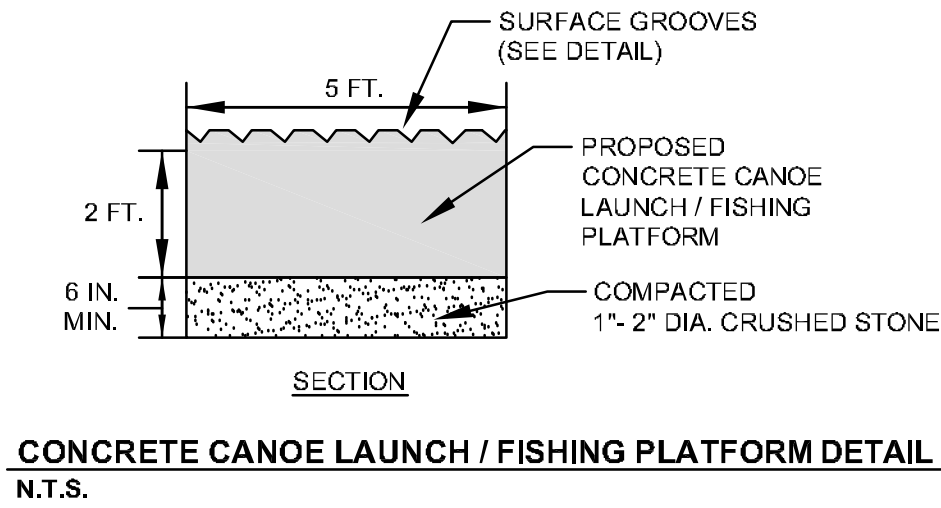
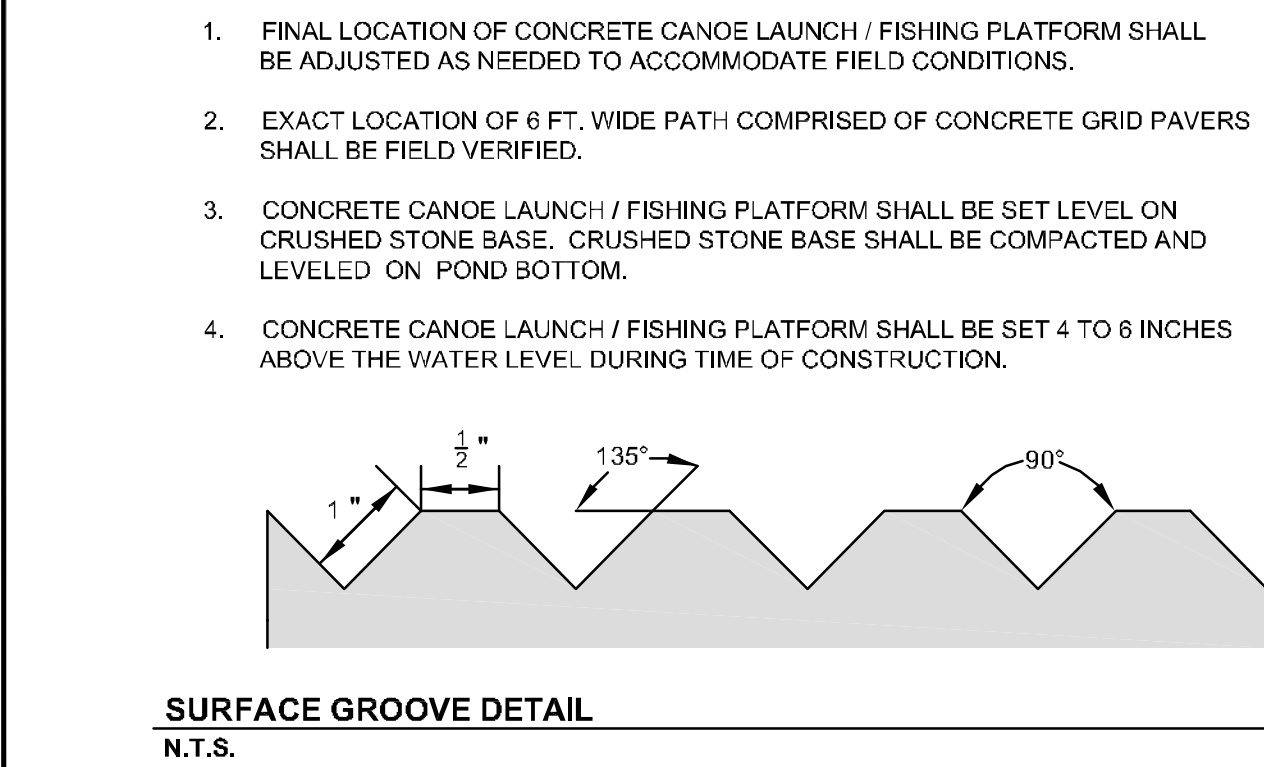
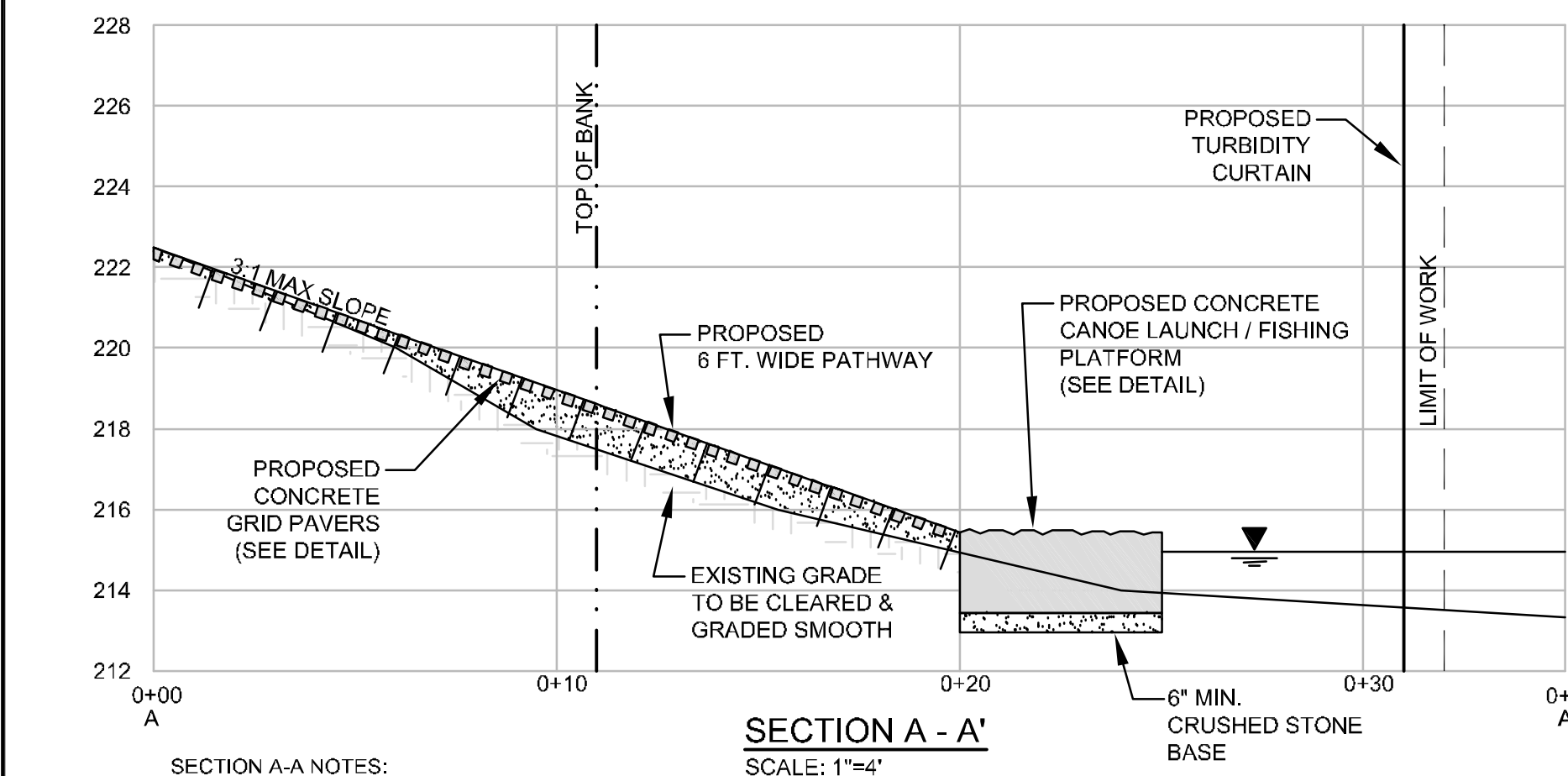
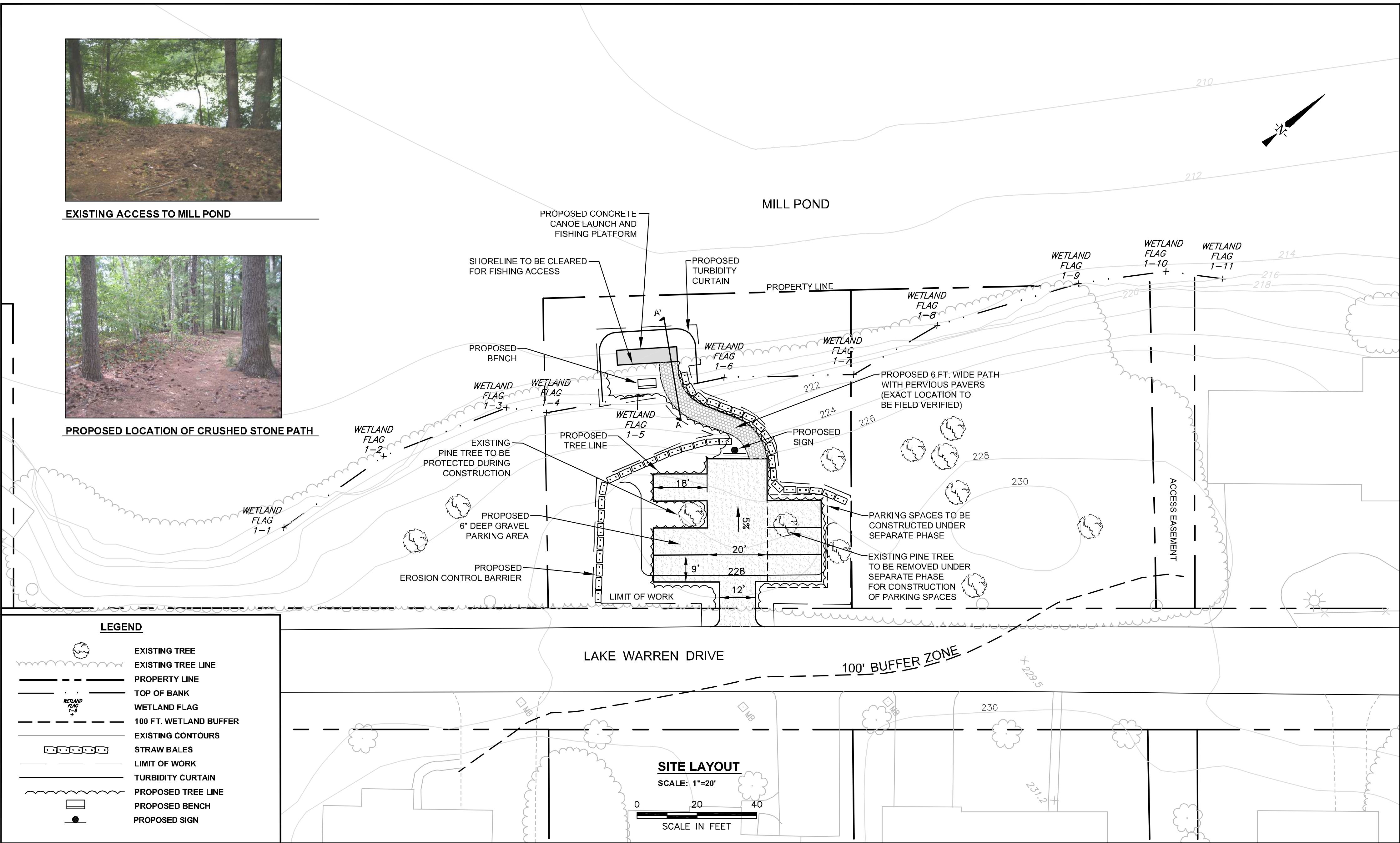

FLOC LOG DETAIL (EROSION CONTROL BARRIER - OPTION 2)
N.T.S.

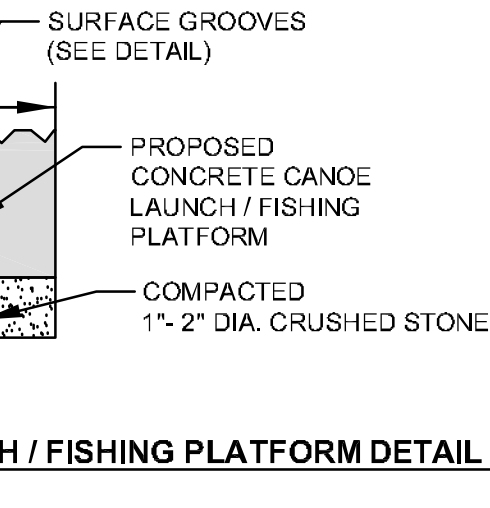

GENERAL GUIDELINES FOR SPACING OF TUBE TRENCHES FOR SLOPE INSTALLATIONS	
SLOPE GRADIENT	TUBE INTERVAL
1H:1V	15 FEET
2H:1V	25 FEET
3H:1V	35 FEET
4H:1V	50 FEET

GENERAL GUIDELINES FOR SPACING OF TUBE TRENCHES FOR CHANNEL INSTALLATIONS	
SLOPE GRADIENT	TUBE INTERVAL
2%	25 FEET

- NOTES:**
- OVERLAP ADJACENT ROLL ENDS BY A MINIMUM OF ONE FOOT AND REDUCE STAKING INTERVAL TO ONE FOOT WITHIN OVERLAP SECTION.
 - FOR CHANNEL APPLICATIONS, BOTH UPSTREAM AND DOWNSTREAM ANCHOR SHOULD BE AT 1 FOOT INTERVALS.

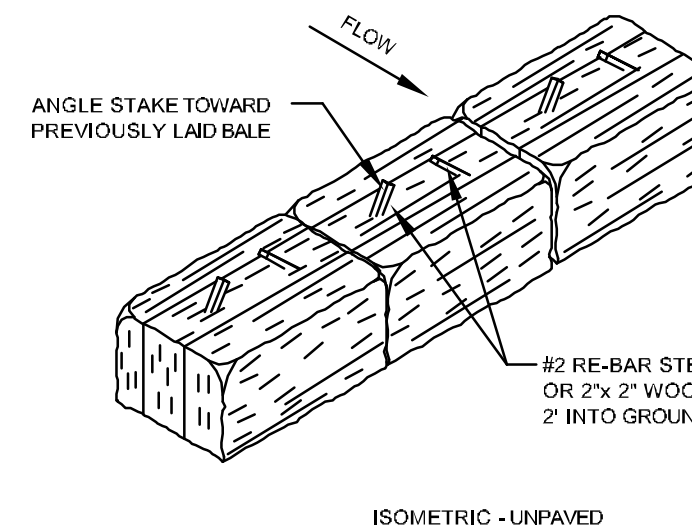

STRAW BALE DETAIL (EROSION CONTROL BARRIER - OPTION 1)
N.T.S.

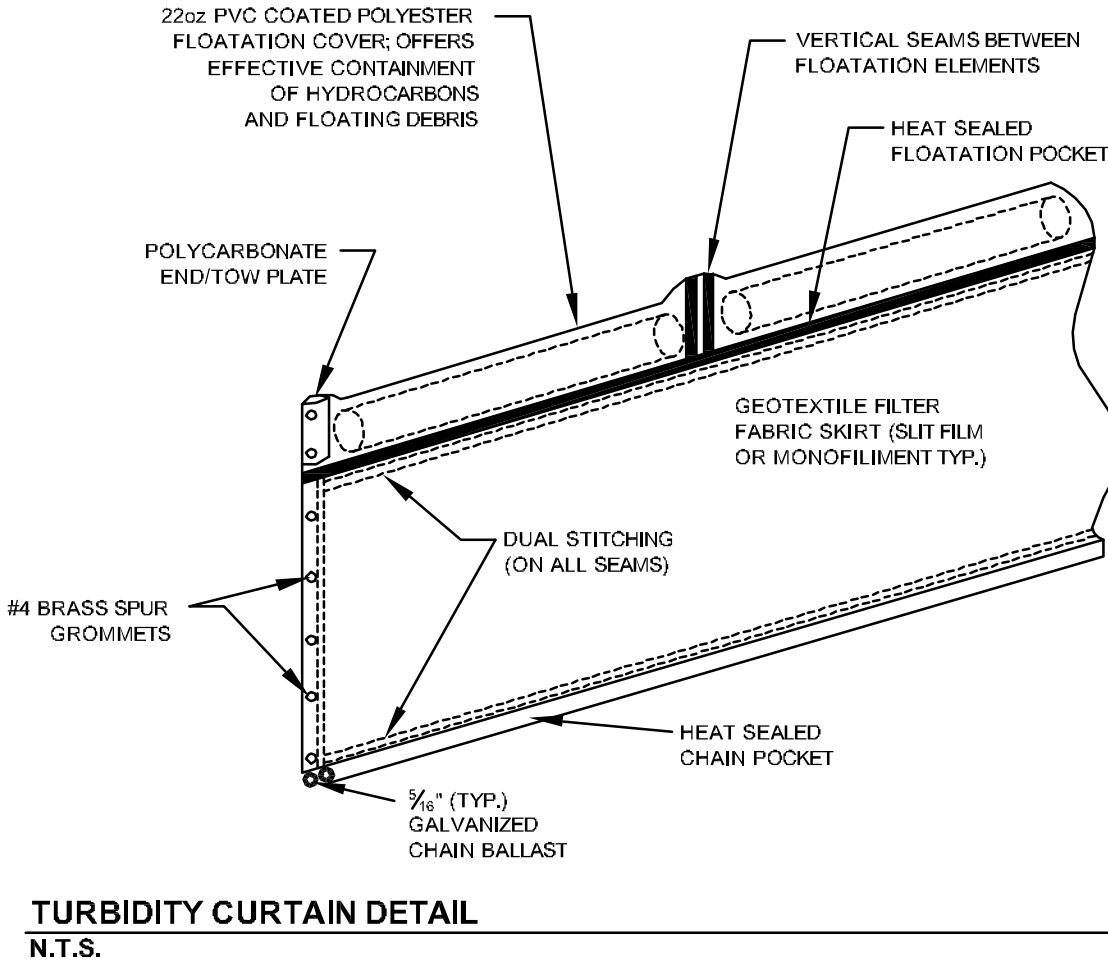

GENERAL NOTES:

- EXISTING GROUND FEATURES, TOPOGRAPHY, AND PROPERTY INFORMATION PROVIDED BY THE TOWN OF LITTLETON IN SEPTEMBER 2000. HORIZONTAL DATUM REFERENCED TO MASSACHUSETTS STATE PLANE (NAD83-FEET). TOPOGRAPHY REFERENCED TO 1929 NGVD AND SHOULD BE CONSIDERED APPROXIMATE.
- WETLAND RESOURCE AREAS WERE DELINEATED BY ESS GROUP, INC. ON AUGUST 18, 2010.
- BORDERING LAND SUBJECT TO FLOODING WAS OBTAINED FROM THE FEMA FLOOD INSURANCE RATE MAP, COMMUNITY-PANEL NO. 25017 C0217 E, EFFECTIVE DATE: JUNE 4, 2010. THE BASE FLOOD ELEVATION IS 216 FEET (NGVD).

SEDIMENTATION & EROSION CONTROL NOTES:

- ALL SOIL AND EROSION CONTROLS SHALL BE PLACED PRIOR TO ANY CONSTRUCTION ACTIVITIES. CONTRACTOR TO NOTIFY LITTLETON CONSERVATION COMMISSION AT LEAST 24 HOURS PRIOR TO ANY CONSTRUCTION ACTIVITIES. ALL SOIL AND EROSION CONTROLS SHALL BE CHECKED AND REPAIRED AS NECESSARY.
- THE CONTRACTOR SHALL BE RESPONSIBLE FOR IMPLEMENTING EROSION CONTROL MEASURES IN ORDER TO PREVENT OFF-SITE TRACKING OF EARTH, SEDIMENT AND DEBRIS.
- AREAS REMAINING UNSTABILIZED FOR A PERIOD OF MORE THAN 30 DAYS SHALL BE TEMPORARILY SEEDED AND MULCHED.
- ALL DISTURBED AREAS NOT OCCUPIED BY PAVEMENT, SIDEWALK OR RIPRAP SHALL BE COVERED WITH 6" (MIN.) OF LOAM AND SEED.
- PERMANENT SEEDING SHALL OCCUR BETWEEN APRIL 1 AND JUNE 1, OR BETWEEN AUGUST 15 AND SEPTEMBER 15.
- SOILS TO BE STOCKPILED FOR A PERIOD OF MORE THAN 30 DAYS SHALL BE SURROUNDED BY EROSION CONTROL BARRIERS AND TEMPORARILY SEEDED AND MULCHED.
- ALL LOAM STOCKPILE AREAS SHALL BE SURROUNDED BY EROSION CONTROL BARRIERS UNTIL SUCH TIME AS THE LOAM IS RESPREAD AND STABILIZED.
- TEMPORARY STORAGE OF MATERIALS ON-SITE IS TO BE LOCATED GREATER THAN 100 FEET FROM WETLAND AREAS, AND AS DIRECTED BY THE ENGINEER. THERE IS TO BE NO LONG TERM STORAGE OF MATERIAL ON-SITE. MATERIAL NOT USED ON-SITE IS TO BE TRUCKED TO AN ACCEPTABLE OFF-SITE DISPOSAL LOCATION.
- EROSION CONTROL MEASURES SHALL BE INSPECTED EVERY WEEK, AND DURING AND AFTER EVERY RAIN EVENT. ANY NECESSARY REPLACEMENT OR REPAIR SHALL BE PERFORMED PROMPTLY BY THE CONTRACTOR.
- THE CONTRACTOR SHALL PHASE SITE CONSTRUCTION TO MINIMIZE THE AREA OF DISTURBED EARTH OPEN TO THE ELEMENTS AT ANY GIVEN TIME. THIS SHALL BE ACHIEVED BY THE FOLLOWING METHODS OR OTHER BEST MANAGEMENT PRACTICES (BMP'S):
 - LOAMING AND SEEDING CUT SLOPES IMMEDIATELY UPON COMPLETION OF SUBGRADE PREPARATION.
 - PLACING AND COMPACTING GRAVEL BASE AND SUBBASE IMMEDIATELY UPON COMPLETION OF SUBGRADE PREPARATION.
 - LIMITING STRIPPING AND STOCKPILING OF LOAM TO AREAS SLATED FOR IMMEDIATE CONSTRUCTION AND STABILIZATION (I.E., PLACEMENT OF GRAVELS, LOAM AND SEED, BUILDING PAD, EROSION CONTROL MATTING, ETC.).

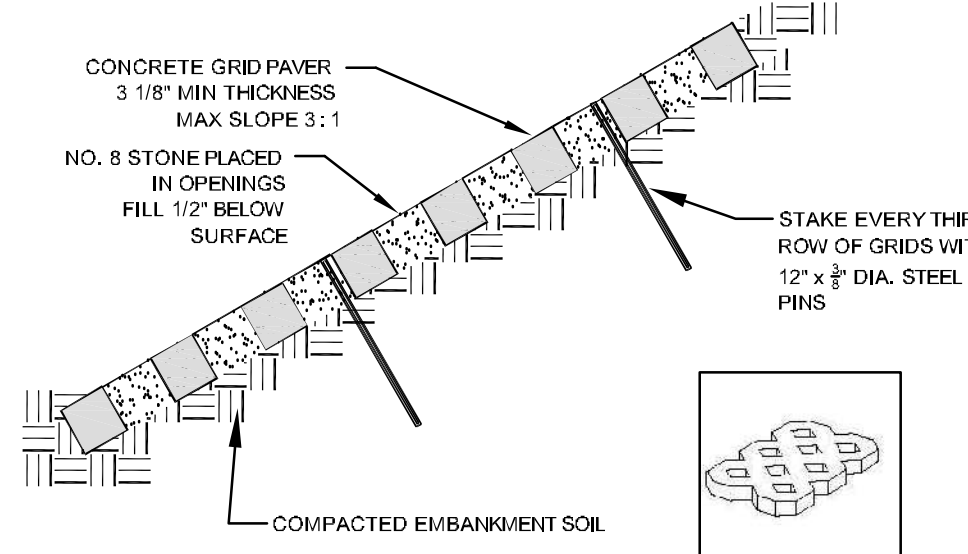

ASTM NO. 8 GRADATION FOR FILL COURSE IN OPENINGS	
SIEVE SIZE	PERCENT PASSING
1/2 IN.	100
3/4 IN.	85 TO 100
NO. 4	10 TO 30
NO. 8	0 TO 10
NO. 16	0 TO 5

- NOTES:**
- THE DESIGN OF THE CONCRETE GRID PAVING UNITS SHALL BE LATTICE.
 - EACH CONCRETE GRID PAVING UNIT SHALL HAVE MAXIMUM DIMENSIONS OF 24" LONG BY 24" WIDE AND A MINIMUM NOMINAL THICKNESS OF 3 1/2". MINIMUM THICKNESS OF THE WEBS BETWEEN OPENINGS SHALL BE 1".

CONCRETE GRID PAVERS FOR SLOPE STABILIZATION
N.T.S.

FOR PERMITTING PURPOSES ONLY

ESS Group, Inc.

Engineers
Scientists
Consultants

888 Worcester Street, Suite 240
Wellesley, Massachusetts 02462
p 781.431.0500
f 781.431.7434
www.essgroup.com

No.	REVISION	DATE	APP BY
1	DRAWN BY: ELU	CHECKED BY: JCB	
2	DESIGNED BY: ELU	APPROVED BY: JCB	

Littleton Water Department
Mill Pond - Public Access
Lake Warren Street
Littleton, Massachusetts

Mill Pond
Public Access
Conceptual Design Plan