

Project 07201-01-0204
Plan 07201-01-002

FORESITE ENGINEERING
10 Pleasantville Road Suite 14
Salem, Massachusetts 01773
www.foresite.com

ENGINEERING
SURVEYING
PLANNING

PREPARED FOR:

K. IMLOCH FARMS, LLC
30 MAGOOD PARK DRIVE SUITE #225
ACTON, MASSACHUSETTS 01720

SCALE: 1" = 50'
DATE: NOVEMBER 8, 2009

"THE HOMES AT KIMLOCH FARM"
A PROPOSED COMPREHENSIVE PERMIT PROJECT UNDER M.G.L. CH. 40B

DRAINAGE CALCULATIONS
PRE-DEVELOPMENT CONDITIONS

SHEET 1 OF 2

COPYRIGHT 2009, FORESITE ENGINEERING, INC. ALL RIGHTS RESERVED.

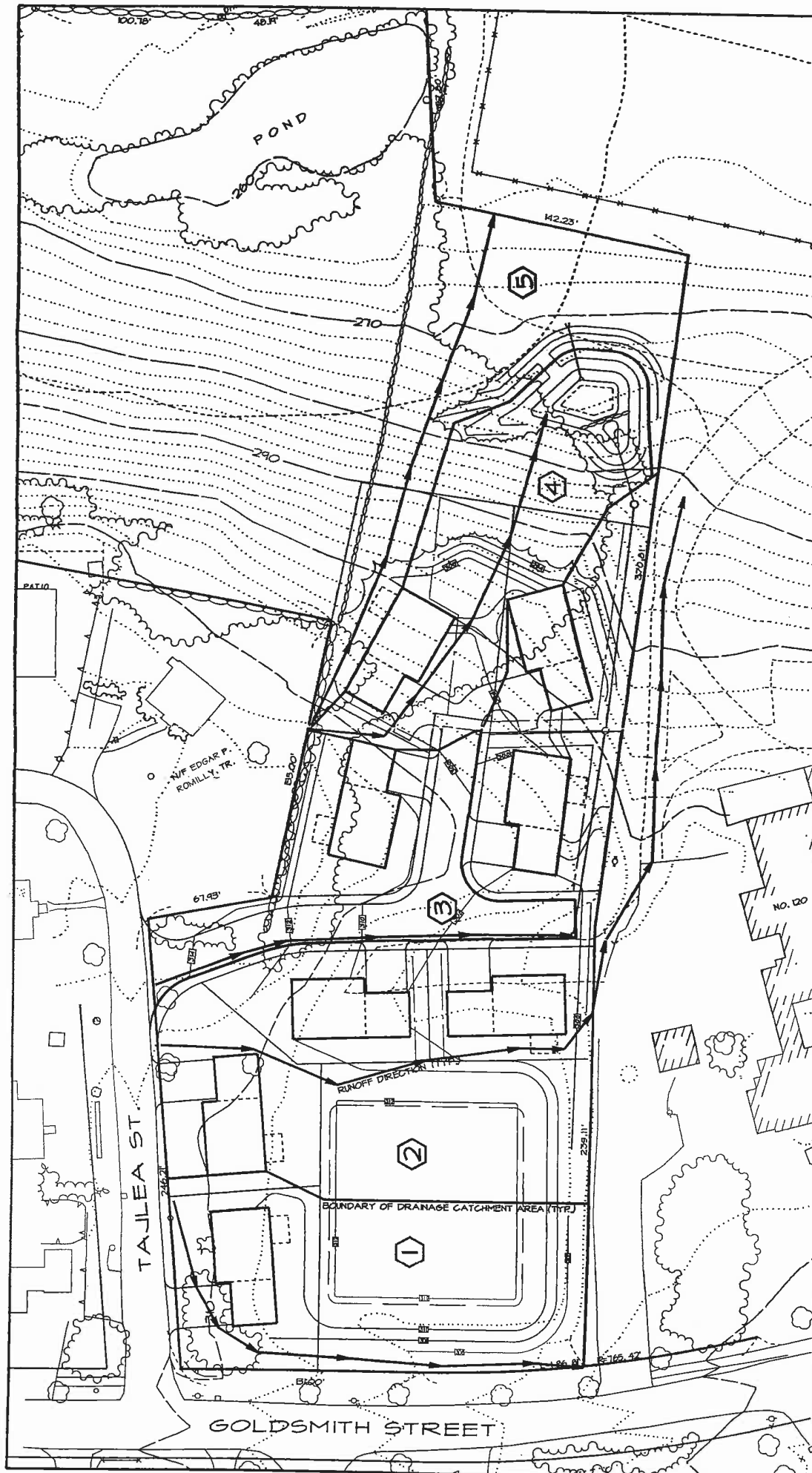

Phone: (978) 491-2350
 Fax: (978) 541-4102



FORESITE
ENGINEERING
 18 Glassdale Road, Suite 1-1
 Stone, Massachusetts 01773

ENGINEERING
 SURVEYING
 PLANNING

www.foresite.com
 12699DRA12D

COPYRIGHT 2009, FORESITE ENGINEERING ASSOCIATES, INC.

KIMLOCH FARMS, LLC
 30 NAGOG PARK DRIVE SUITE #225
 ACTON, MASSACHUSETTS 01720

PREPARED FOR:

SCALE: 1"=50'
 DATE: NOVEMBER 8, 2009

"THE HOMES AT KIMLOCH FARM"
 A PROPOSED COMPREHENSIVE PERMIT PROJECT UNDER M.G.L. CH. 40B

DRAINAGE CALCULATIONS
POST-DEVELOPMENT CONDITIONS

SHEET 2 OF 2