

CULTEC CONTACTOR 100 CHAMBER OR APPROVED EQUAL

TYPICAL RECHARGE
(NOT TO SCALE)

CONSTRUCTION SEQUENCE:

1. CALL DIGSAFE A MINIMUM OF 72 HOURS PRIOR TO COMMENCING CONSTRUCTION ACTIVITIES AT 1-888-344-7233.
2. CONSTRUCT TEMPORARY AND PERMANENT SEDIMENT AND EROSION CONTROL FACILITIES. EROSION AND SEDIMENT CONTROL MEASURES SHALL BE INSTALLED PRIOR TO ANY EARTH MOVING OPERATION THAT WILL INFLUENCE STORMWATER RUNOFF.
3. CUT AND CLEAR TREES IN CONSTRUCTION AREAS ONLY.
4. RAZE EXISTING DWELLING AND ASSOCIATED STRUCTURES & IMPROVEMENTS.
5. CLEAR AND DISPOSE OF DEBRIS FROM CONSTRUCTION AREAS.
6. INSTALL NEW FOUNDATION.
7. BEGIN INSTALLATION OF SEPTIC SYSTEM.
8. CONTINUE WITH DWELLING CONSTRUCTION.
9. INSPECT SEDIMENT CONTROLS OFTEN AND REPLACE AS NEEDED.
10. INSTALL UNDERGROUND UTILITIES.
11. GRADE AND GRAVEL DRIVEWAY, WHICH SHALL BE STABILIZED IMMEDIATELY AFTER GRADING.
12. PAVE NEW DRIVEWAY.
13. COMPLETE PERMANENT GRADING, SEEDING AND LANDSCAPING.
14. REMOVE TRAPPED SEDIMENTS FROM COLLECTOR DEVICES AS APPROPRIATE AND THEN REMOVE TEMPORARY EROSION CONTROL MEASURES.

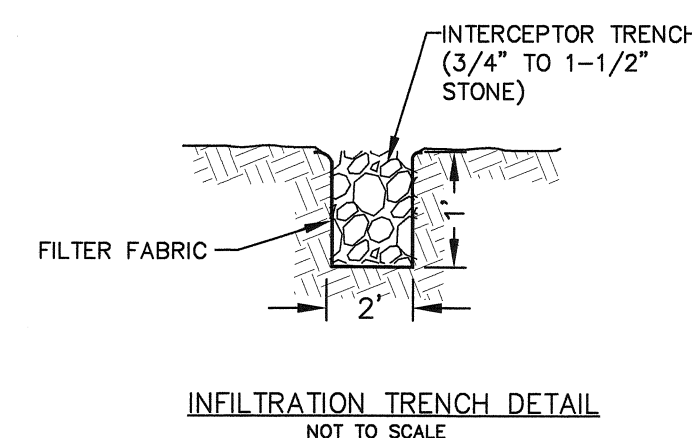
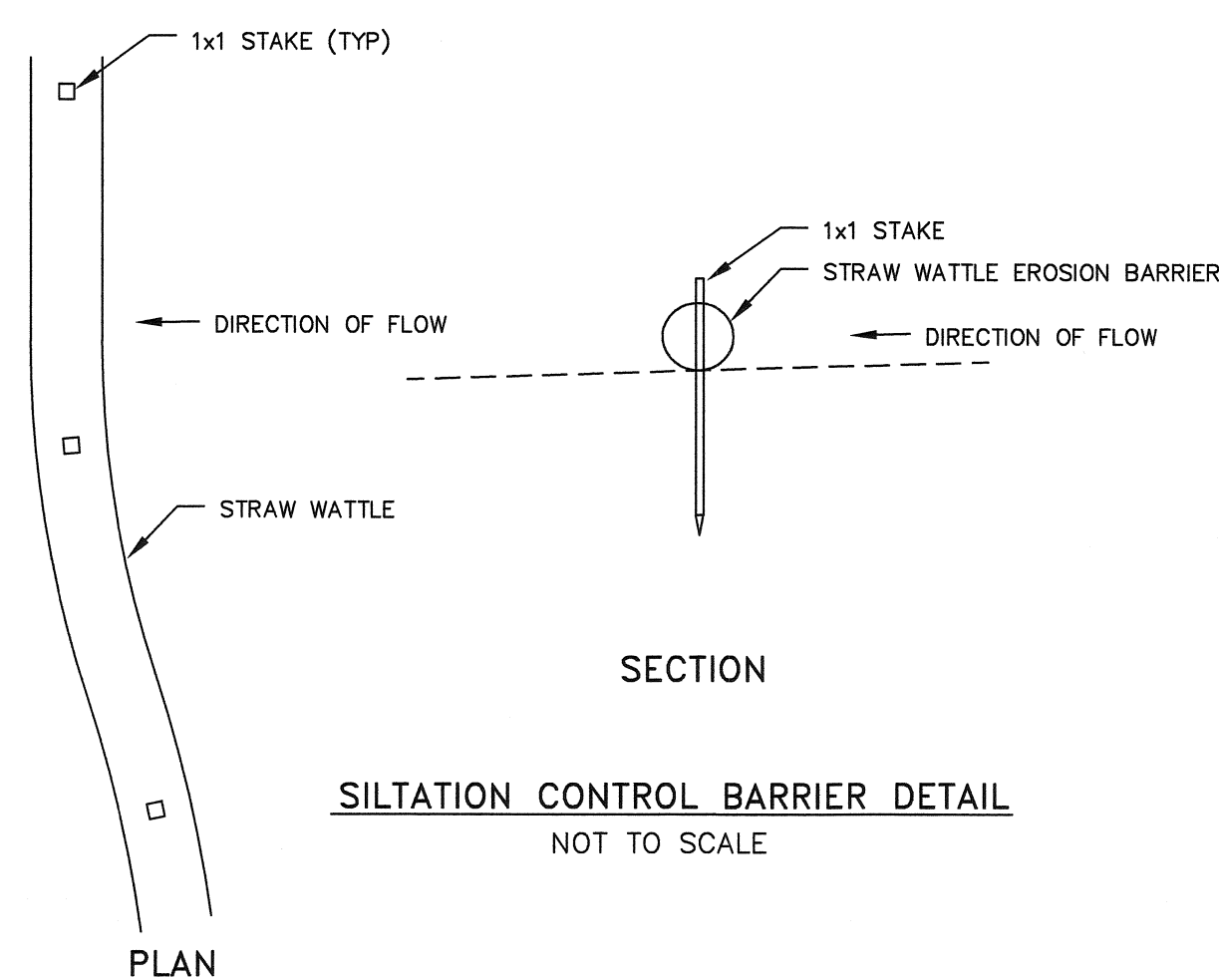

DEEP HOLE TEST

TP-1
DATE: 5/10/23
ELEV: 100.5
0" A 10 YR 3/2 FSL
12" B 2.5 Y 6/6 SL
72" C 2.5 Y 5/6 LS

WEeping *
OBS. WATER *
ESHWT *
ELEV. *

DEEP HOLE TEST

TP-2
DATE: 5/10/23
ELEV: 100.0
0" A 10 YR 3/2 FSL
16" B 2.5 Y 6/6 SL
102" C 2.5 Y 5/6 LS

WEeping *
OBS. WATER *
ESHWT *
ELEV. *

DEEP HOLE TEST

TP-3
DATE: 5/10/23
ELEV: 94.5
0" FILL
48" C 2.5 Y 6/6 LS
108" C 2.5 Y 6/6 LS

WEeping *
OBS. WATER *
ESHWT *
ELEV. *

GRAPHIC SCALE

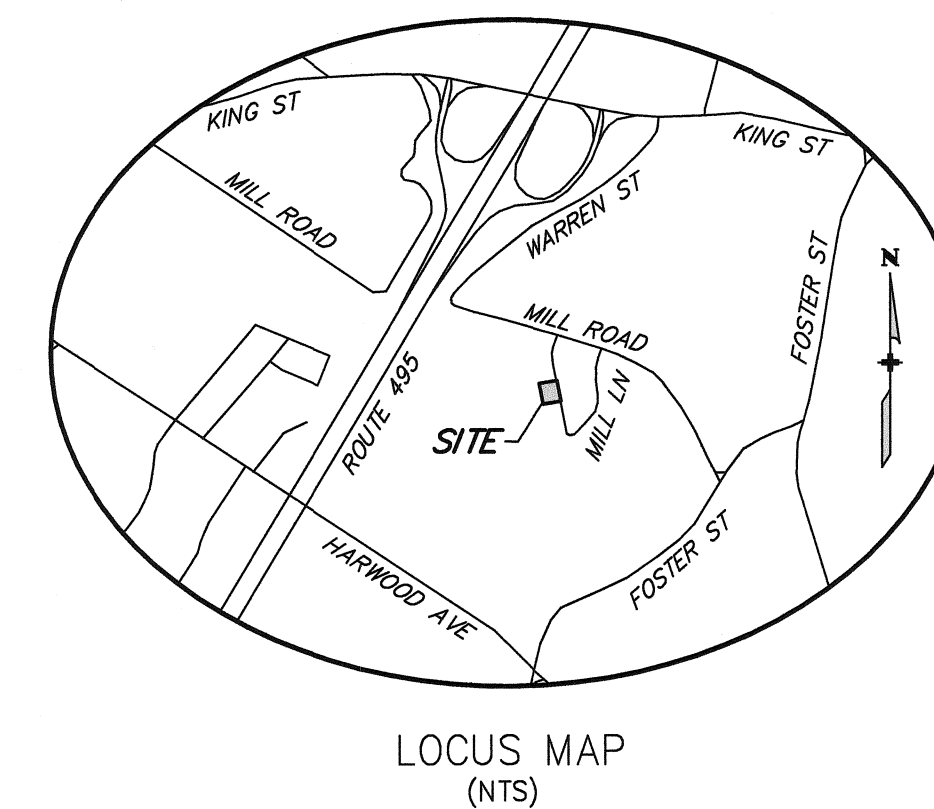
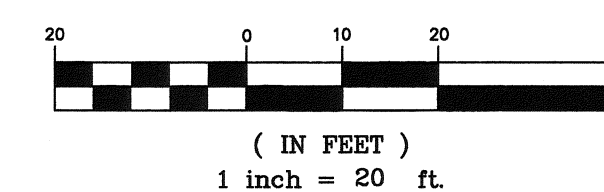

LEGEND

- 100x0 M.S.D.R.D.
- EXISTING SPOT GRADE
- MIDDLESEX SOUTH DISTRICT
- REGISTRY OF DEEDS
- EXISTING EDGE OF PAVEMENT
- PROPERTY LINE
- EDGE OF WETLAND
- PROPOSED STRAW WATTLES

NOTES:

1. ASSESSORS MAP 35 PARCEL 25.
2. SITE IS ZONED RESIDENCE MINIMUM SETBACKS FRONT 30' SIDE 15' REAR 15'
3. THE SITE IS OUTSIDE OF THE FLOOD HAZARD AREA AS SHOWN OF THE FEMA FLOOD INSURANCE RATE MAP COMMUNITY PANEL NUMBER 250200 0236 F, DATED JULY 7, 2014.
4. WETLAND FLAGS WERE FIELD LOCATED BY THIS OFFICE.
5. TOPOGRAPHY IS FROM A FIELD SURVEY BY THIS OFFICE ON AN ASSUMED DATUM.
6. OWNER OF RECORD: M & B INVESTMENTS, LLC 31 DIAMOND STREET N. CHELMSFORD, MA 01863
7. DEED REFERENCE: M.S.D.R.D. L.C. BOOK 1599, PAGE 192
8. PLAN REFERENCE: M.S.D.R.D. L.C. PLAN 28631A

ASSESSORS MAP 35, PARCEL 25
M.S.D.R.D. L.C. BOOK 1599, PAGE 192

NOTICE OF INTENT PLAN
IN
LITTLETON, MASSACHUSETTS

#30 MILL LANE

SCALE: 1"=20' DATE: AUGUST 17, 2023 SHEET 1 OF 1 REV.

PREPARED FOR OWNER/APPLICANT
M & B INVESTMENTS, LLC, 31 DIAMOND STREET
N. CHELMSFORD, MA 01863, PHONE: (978)490-0575
PREPARED BY
Land Engineering & Environmental Services, Inc.
One Bridgeview Circle, Tyngsboro, Massachusetts 01879
Telephone (978) 649-4642