

TEST PIT DATA:

DATE OF TESTING: 05/15/2025
TEST BY: STAMSKI AND McNARY, INC.
CERT. SOIL EVAL. PAUL KIRCHNER, SE14237
WITNESSED BY: JAMES GARRETT

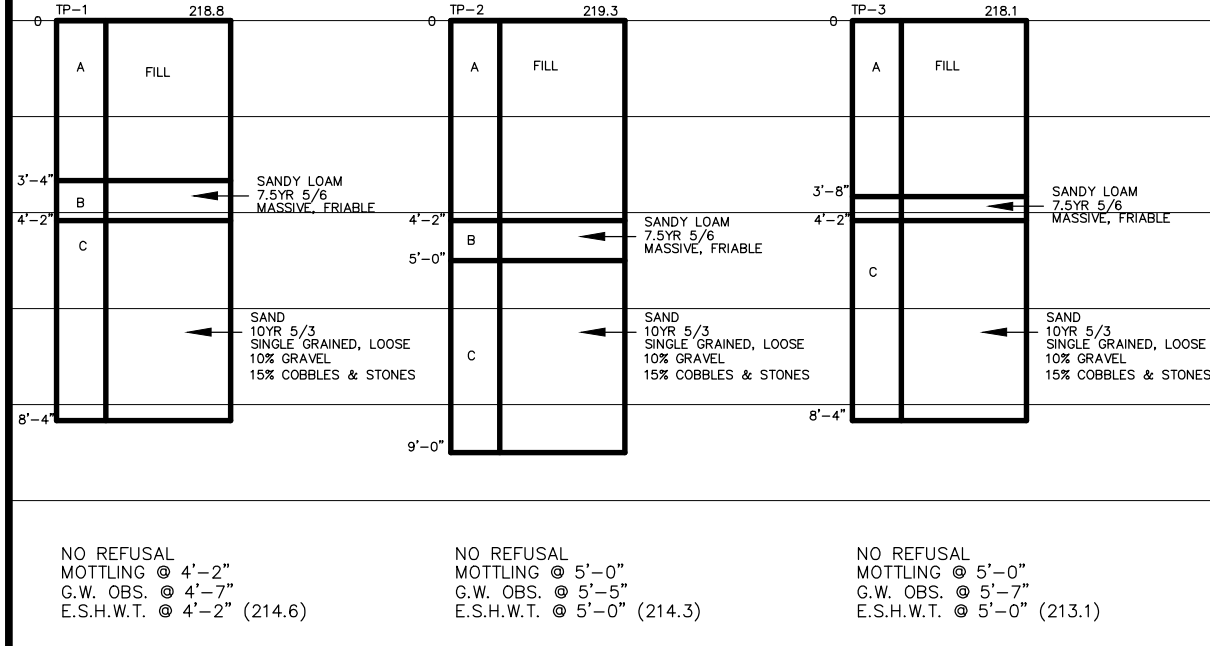

NOTES:

- THIS PLAN IS FOR THE DESIGN AND CONSTRUCTION OF A SEWAGE DISPOSAL FACILITY ONLY.
- ALL CONSTRUCTION METHODS AND MATERIALS SHALL CONFORM TO TITLE 5 AND THE LITTLETON BOARD OF HEALTH REGULATIONS.
- IF ALTERATIONS (REMOVAL OF VEGETATION, GRADING, EXCAVATIONS, ETC.) ARE TO BE MADE WITHIN 100 FT OF WETLAND AREAS (PONDS, BROOKS, SWAMPS, ETC.) A REQUEST FOR DETERMINATION OF APPLICABILITY OF THE WETLANDS PROTECTION ACT (c131 s40A) SHOULD BE FILED WITH THE TOWN'S CONSERVATION COMMISSION. THE FILING OF A NOTICE OF INTENT MAY BE REQUIRED AND LOCAL BYLAWS MAY APPLY.
- ACCEPTABLE MATERIAL SPECIFICATIONS FOR DISTRIBUTION LINES: PVC-SCHEDULE 40, SDR 21, ABS-SCHEDULE 40, SCHEDULE 40 PVC SHALL BE USED IN AREAS SUBJECT TO VEHICULAR TRAFFIC.
- UNLESS OTHERWISE SHOWN, THERE ARE NO KNOWN WELLS WITHIN 150' OF THE PROPOSED SEWAGE DISPOSAL SYSTEM.
- ALL TOP, SUBSOIL, FILL, BOULDERS, AND OTHER MATERIALS UNDER THE PROPOSED LEACHING AREA SHALL BE REMOVED AND REPLACED WITH SUITABLE MATERIAL ACCORDING TO TITLE 5 SECTION 15.255.
- "CONSTRUCTION IN FILL": A 5' OVER DIG AROUND THE SYSTEM SAND IS NOT REQUIRED AS SPECIFIED IN THE MODIFIED REMEDIAL USE CERTIFICATION FOR PRESBY ADVANCED ENVIRO-SEPTIC, SPECIAL CONDITION 6. PER TITLE 5 REQUIREMENTS, THE DESIGN ENGINEER IS REQUIRED TO INSPECT CONSTRUCTION OF THE SEPTIC SYSTEM AND CERTIFY THAT THE SYSTEM IS CONSTRUCTED ACCORDING TO THE PLANS, LOCAL REGULATIONS, AND TITLE 5. IN MOST INSTANCES THE DESIGN ENGINEER IS ALSO REQUIRED TO PREPARE AN "AS-BUILT" PLAN, UNLESS OTHERWISE SPECIFICALLY STATED IN WRITING BETWEEN OWNER AND THE INSTALLER. THE INSTALLER SHALL BE RESPONSIBLE FOR COORDINATING INSPECTIONS WITH THE DESIGN ENGINEER AND PAY FOR THESE SERVICES. NOTIFYING THE DESIGN ENGINEER DOES NOT RELIEVE THE OWNER OR INSTALLER FROM THE RESPONSIBILITY OF HAVING THE REQUIRED INSPECTIONS ETC. BY THE BOARD OF HEALTH.
- FINISHED GRADE OVER THE LEACHING AREA SHALL HAVE A MINIMUM SLOPE OF 2%.
- THE FIRST TWO FOOT SECTIONS OF PIPE FROM THE DISTRIBUTION BOX SHALL BE SET LEVEL.
- THE SYSTEM, INCLUDING SEPTIC TANK, SHALL BE STAKED AND THE BENCHMARK SET IN THE FIELD BY THE DESIGN ENGINEER.
- ALL UNDERGROUND UTILITIES SHOWN HERE WERE COMPILED ACCORDING TO AVAILABLE RECORD PLANS FROM VARIOUS UTILITY COMPANIES AND PUBLIC AGENCIES AND ARE APPROXIMATE ONLY. ACTUAL LOCATIONS MUST BE DETERMINED BEFORE DESIGNING, EXCAVATING, BLASTING, INSTALLING, BACKFILLING, GRADING, OR PAVEMENT RESTORATION OR REPAIR. ALL UTILITY COMPANIES, PUBLIC AND PRIVATE, MUST BE CONTACTED, INCLUDING THOSE IN CONTROL OF UTILITIES. SEE CHAPTER 370, ACTS OF 1963 MASS. WE ASSUME NO RESPONSIBILITY FOR DAMAGES INCURRED AS A RESULT OF UTILITIES OMITTED OR INACCURATELY SHOWN. BEFORE PLANNING FUTURE CONNECTIONS, THE APPROPRIATE UTILITY ENGINEERING DEPARTMENT MUST BE CONSULTED. D.I.G. SAFE TELE. NO. 1-888-344-7233
- THIS SEPTIC SYSTEM IS NOT DESIGNED FOR A GARBAGE GRINDER.
- ALL SYSTEM COMPONENTS SHALL BE MARKED WITH MAGNETIC MARKING TAPE OR A COMPARABLE MEANS IN ORDER TO BE LOCATED EASILY BURIED.
- ALL DISTURBED SURFACES SHALL BE RESTORED WITH 4" OF LOAM AND SEED.
- THE BYPASS VENT VENT AS THE HIGH VENT IF THERE ARE NO PUMPS, RESTRICTIONS, OR OTHER VENTS BETWEEN THE LOW VENT AND THE ROOF VENT. IF A RESTRICTION IS PLACED BETWEEN THE LOW VENT AND THE ROOF VENT, A HIGH VENT IS REQUIRED THROUGH AN UNUSED DISTRIBUTION BOX OUTLET. ALTERNATIVELY, IF A HIGH VENT IS NEEDED, THE DISTRIBUTION BOX MAY BE CONNECTED TO AN UNUSED SEPTIC TANK INLET TO ALLOW THE BUILDING STACK TO ACT AS THE HIGH VENT. IF AN EFFLUENT FILTER IS USED, IT MUST BE MAINTAINED TO ENSURE ADEQUATE AIR FLOW.
- FINAL VENT LOCATION SUBJECT TO OWNER'S APPROVAL.
- SEWER MANHOLES BROUGHT TO FINISH GRADE SHALL BE SECURED TO PREVENT UNAUTHORIZED ACCESS.
- THE PRESBY ADVANCED ENVIRO-SEPTIC LEACHING SYSTEM HAS BEEN CERTIFIED FOR REMEDIAL USE; THIS SYSTEM SHALL BE INSTALLED AND OPERATED IN COMPLIANCE WITH THE MODIFIED APPROVAL FOR REMEDIAL USE MODIFIED MARCH 15, 2022, TRANSMITTAL NUMBER 21-CLM-000073-APP. AS THE DESIGNER OF RECORD, WE HEREBY CERTIFY WE HAVE RECEIVED THE REQUIRED TRAINING AND THE PLAN IS IN ACCORDANCE WITH THE LATEST DEP I/A APPROVAL.
- THE EXISTING SEPTIC TANK SHALL BE PUMPED DRY, BOTTOM RUPTURED AND BACKFILLED WITH CLEAN SAND IN ACCORDANCE WITH TITLE 5, SECTION 15.354 "ABANDONMENT OF SYSTEMS" OR DISPOSED OFFSITE. IF THE EXISTING LEACH FIELD MAY BE ENCOUNTERED, SOIL SPOILS MAY BE PLACED AS GENERAL FILL WITH ONE FOOT OF COVER. THE REMAINDER OF THE LEACH FIELD MAY BE ABANDONED IN PLACE.
- PRIOR TO PURCHASING ANY SYSTEM COMPONENTS, CONTRACTORS SHALL VERIFY EXISTING BUILDING INVERT. ANY DISCREPANCIES SHALL BE REPORTED TO THE DESIGN ENGINEERS.
- ZABEL EFFLUENT TEE FILTER SHALL BE INSTALLED IN COMPLIANCE WITH APPROVAL ISSUED AUGUST 11, 1997. ALL SEWER MANHOLES AT FINISHED GRADE SHALL BE SECURED TO PREVENT UNAUTHORIZED ACCESS. BOTH INLET AND OUTLET MANHOLES MUST BE CLEARLY AND PERMANENTLY NOTE THAT THE SYSTEM IS EQUIPPED WITH THE ZABEL 41800 FILTER.
- A WAIVER HAS BEEN REQUESTED UNDER THE TOWN OF LITTLETON WETLANDS PROTECTION REGULATIONS FOR THE WORK PROPOSED WITH THE 50' NO-DISTURB ZONE.
- TOWN OF LITTLETON BOARD OF HEALTH ENACTMENTS, CHAPTER 223 REGULATION 27 - FILL REQUIREMENTS:
REQUIRED: FILL > 10" FROM PROPERTY LINE FOR A SUBSURFACE SEWAGE DISPOSAL SYSTEM.
PROVIDED: 2"

PROFILE: SCALE: 1"= 20' H. 1"= 4' V.

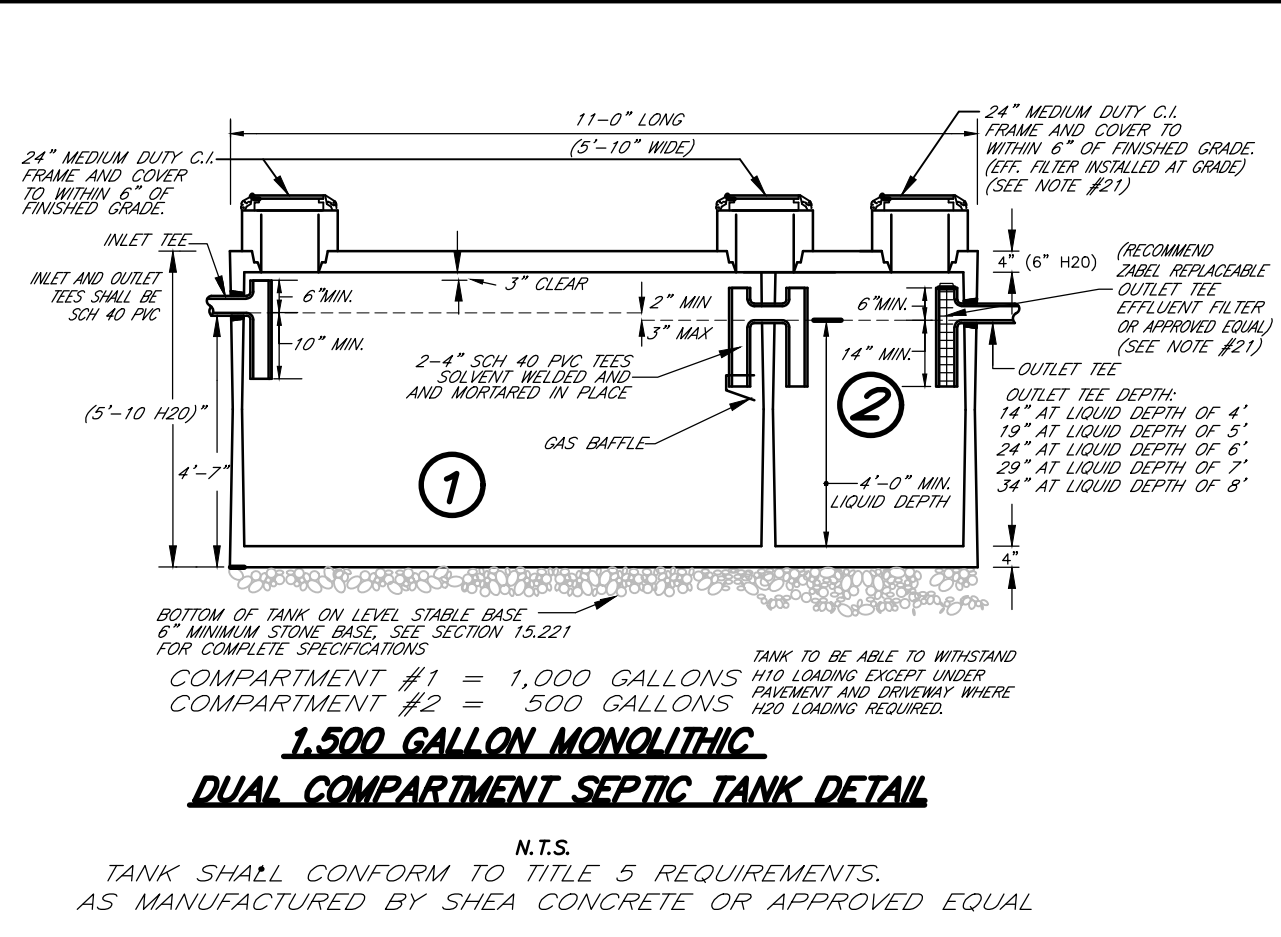
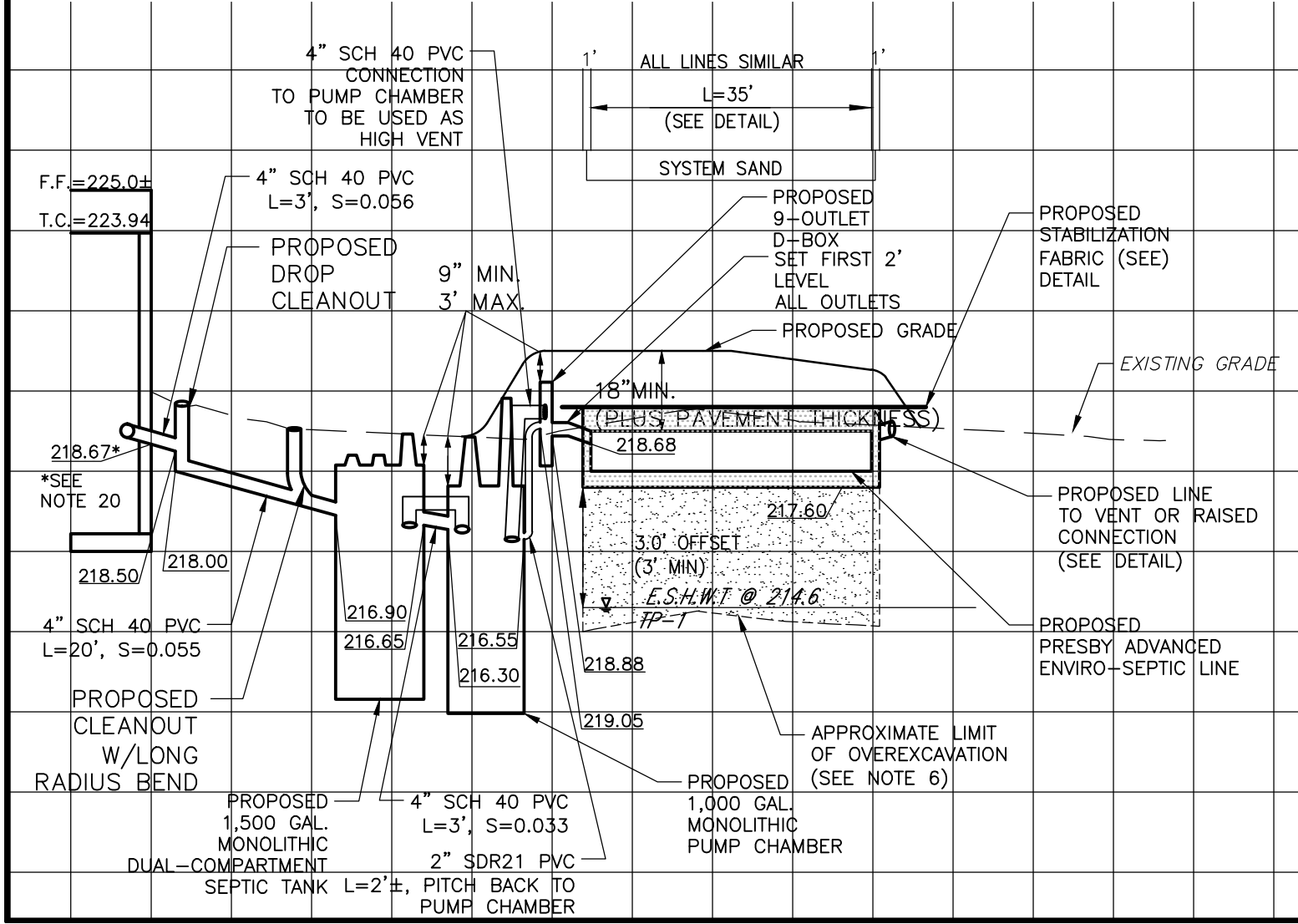

LEGEND:

- N/F NOW OR FORMERLY
- OHV OVERHEAD WIRES
- TREE TREE LINE
- UTILITY POLE
- GG GAS GATE
- WG GAS SERVICE (BURIED)
- W WATER GATE
- DMH DRAIN MANHOLE
- EXISTING CONTOUR
- EXISTING CONTOUR
- LIGHTPOLE
- WETLAND FLAG
- SPOT ELEVATION
- STONE WALL
- F.F. FIRST FLOOR ELEV.
- T.C. TOP OF CONCRETE ELEV.
- B.F. BASEMENT FLOOR ELEV.
- G.F. GARAGE FLOOR ELEV.
- T.B.R. TO BE REMOVED

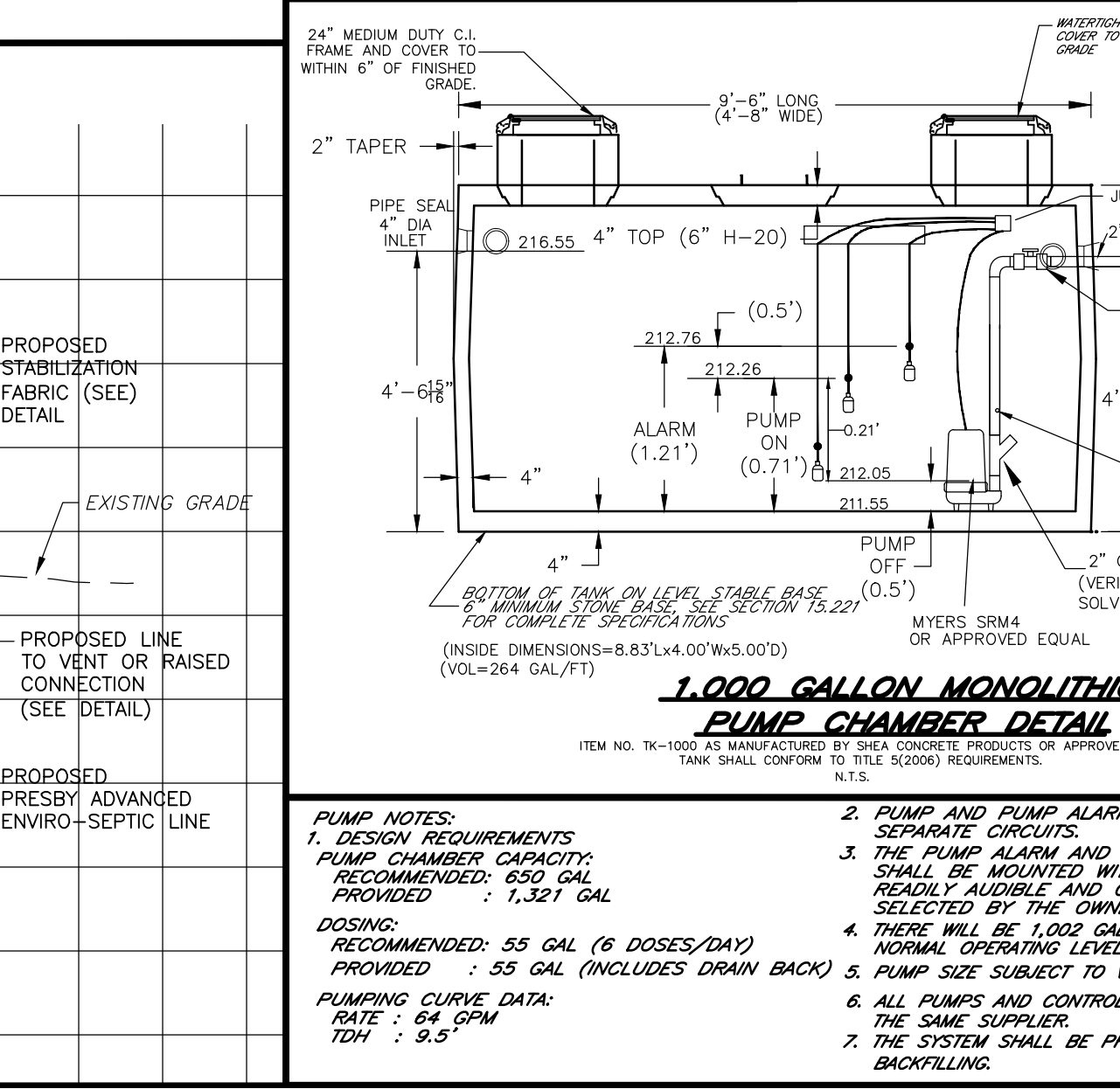
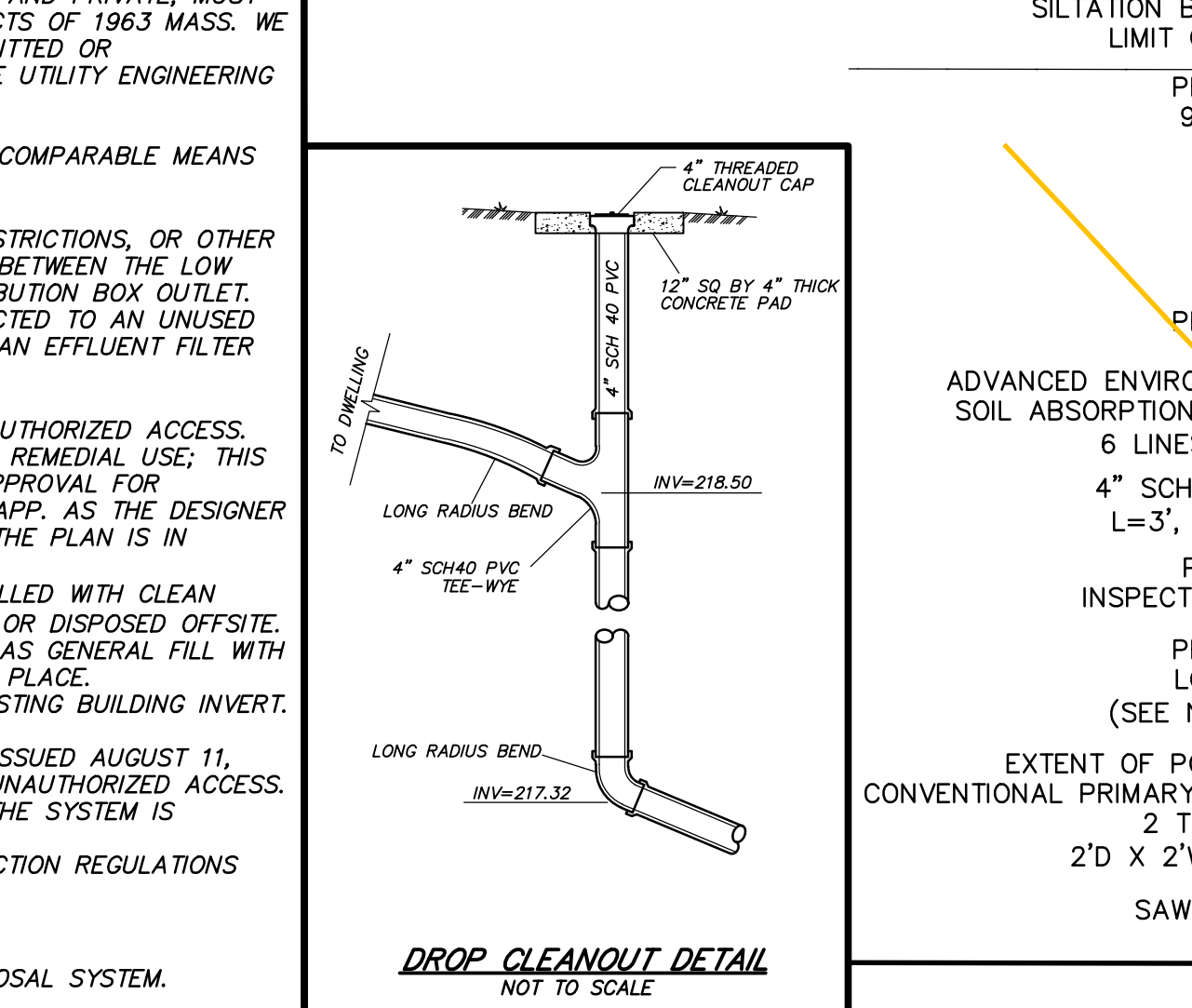

D.BOX DETAIL:

TO CONFORM TO TITLE 5 REQUIREMENTS
NO. OF OUTLETS: 9

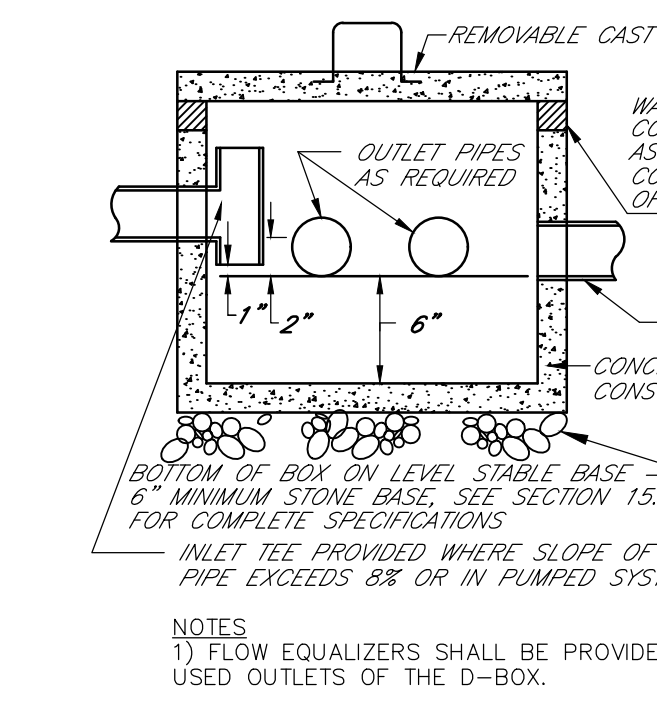

PLAN VIEW:

ZONING DISTRICT: RESIDENCE
AQUIFER ZONING OVERLAY DISTRICT
SCALE: 1"=20'

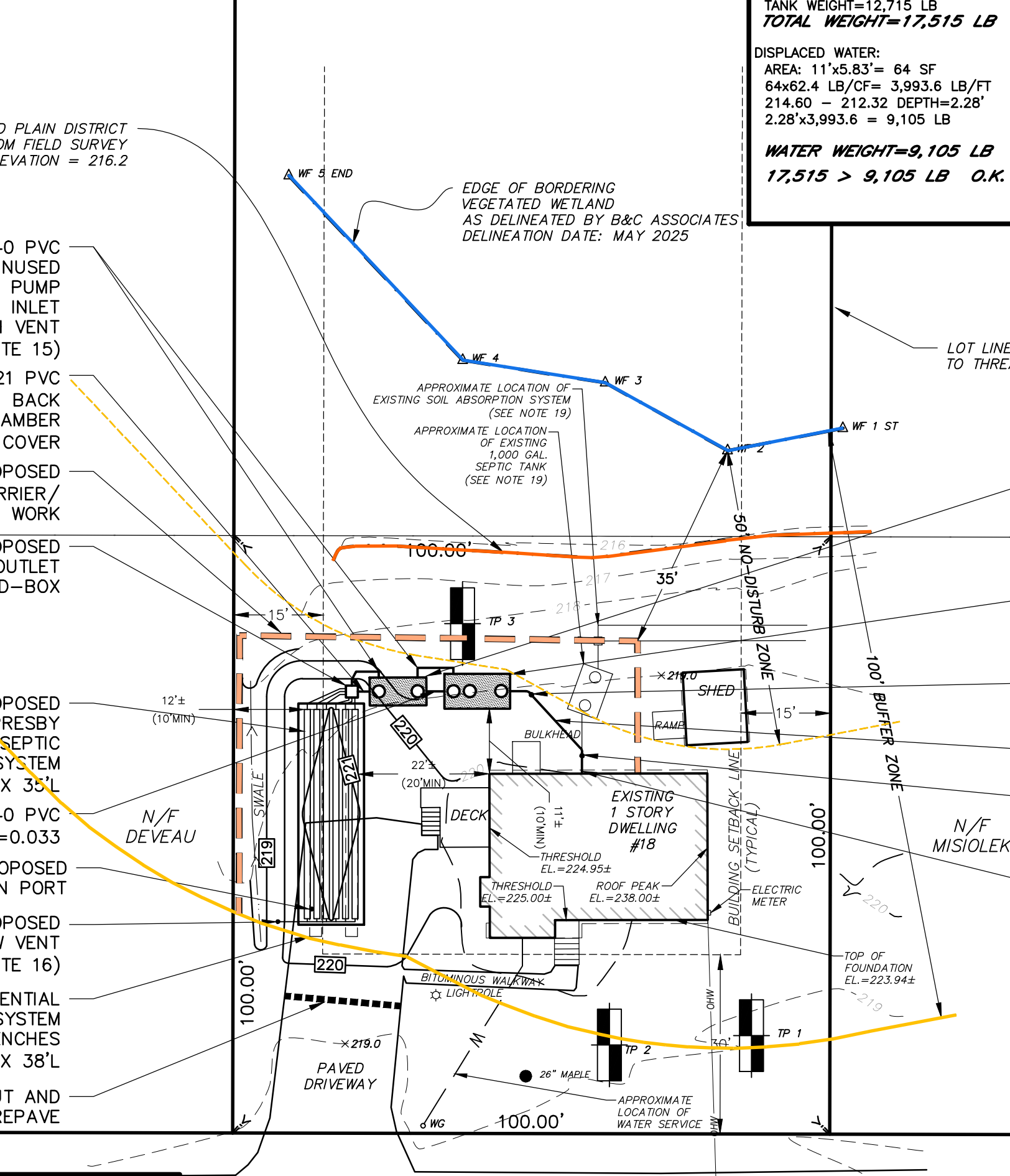

PLEASANT STREET

(PUBLIC - 40' WIDE)

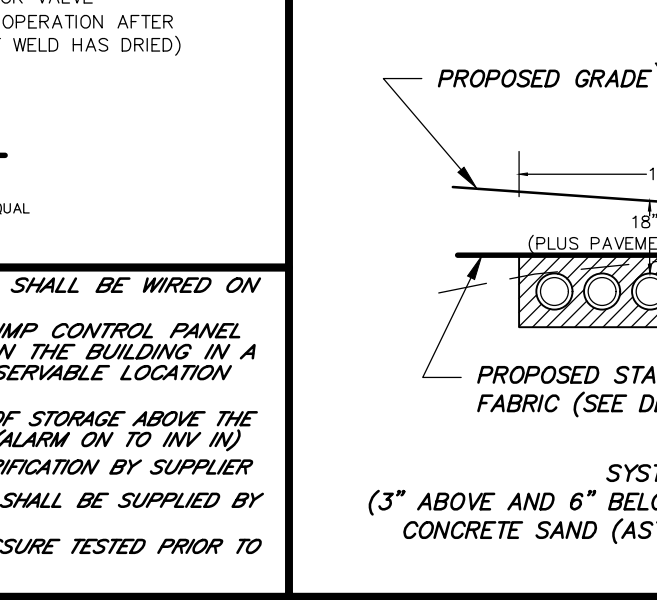
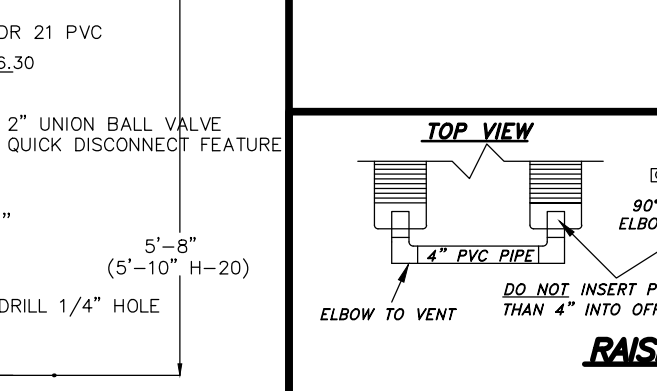

SOIL ABSORPTION SYSTEM:

PRESBY ADVANCED ENVIRO-SEPTIC LEACHING SYSTEM
SCH 40 PVC TO LOW VENT
CONNECT TO UNUSED PUMP CHAMBER INLET TO ACT AS HIGH VENT

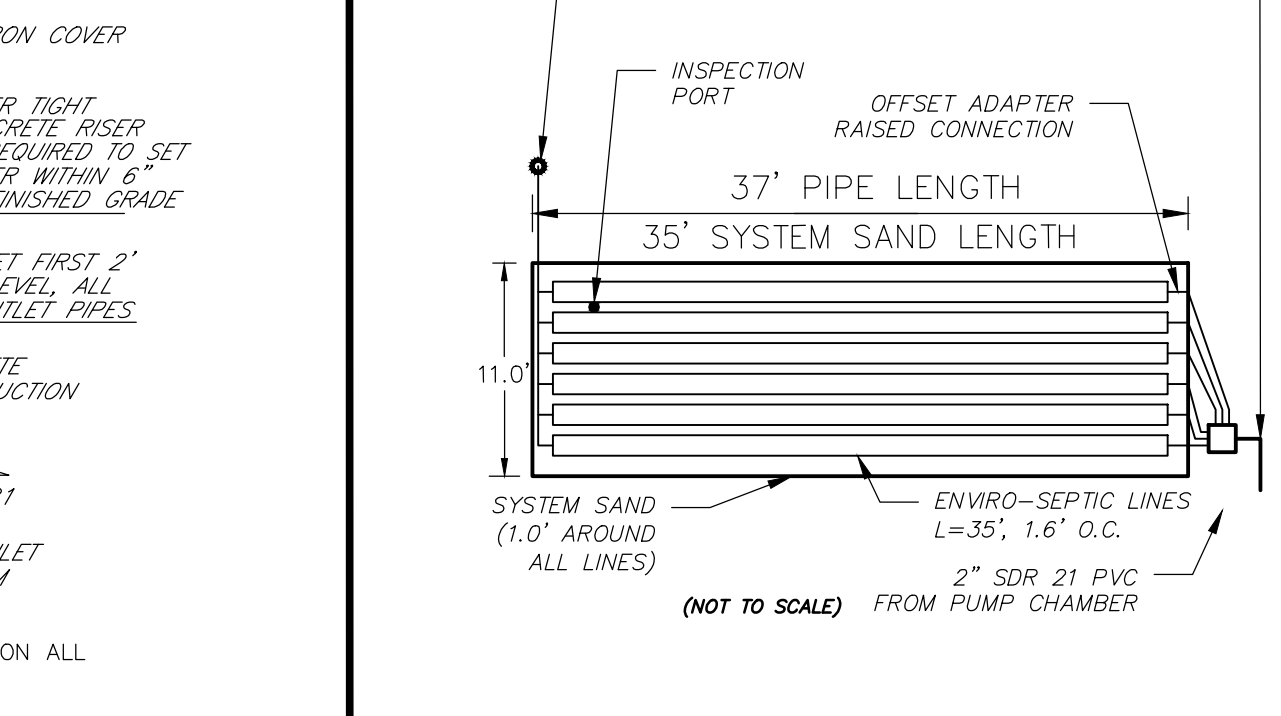

BOUYANCY CALCULATIONS:

SEPTIC TANK: 1,500 GAL.
WEIGHT OF OVERBURDEN:
AREA: 11'x5.83' = 64 SF
SOIL: (0.78' DEPTH)
0.75'x64.0 SFx100 LB/CF=4,800 LB
TANK WEIGHT=12,715 LB
TOTAL WEIGHT=17,515 LB
DISPLACED WATER:
AREA: 11'x5.83' = 64 SF
44.4x62.4 LB/CF=2,770.6 LB/FT
214.60 - 212.32 DEPTH=2.28'
2.28'x3,993.6 = 9,105 LB
WATER WEIGHT=9,105 LB
17,515 > 9,105 LB O.K.

BOUYANCY CALCULATIONS:

PUMP CHAMBER: 1,000 GAL.
WEIGHT OF OVERBURDEN:
AREA: 9.5'x4.67' = 44.4 SF
SOIL: (0.78' DEPTH)
0.75'x44.4 SFx100 LB/CF=3,300 LB
TANK WEIGHT=10,800 LB
TOTAL WEIGHT=14,100 LB
DISPLACED WATER:
AREA: 9.5'x4.67' = 44.4 SF
44.4x62.4 LB/CF=2,770.6 LB/FT
214.60 - 212.0 DEPTH= 2.6'
2.6'x2,770.6 = 7,204 LB
WATER WEIGHT=7,204 LB
14,100 > 7,204 LB O.K.

STABILIZATION FABRIC DETAIL

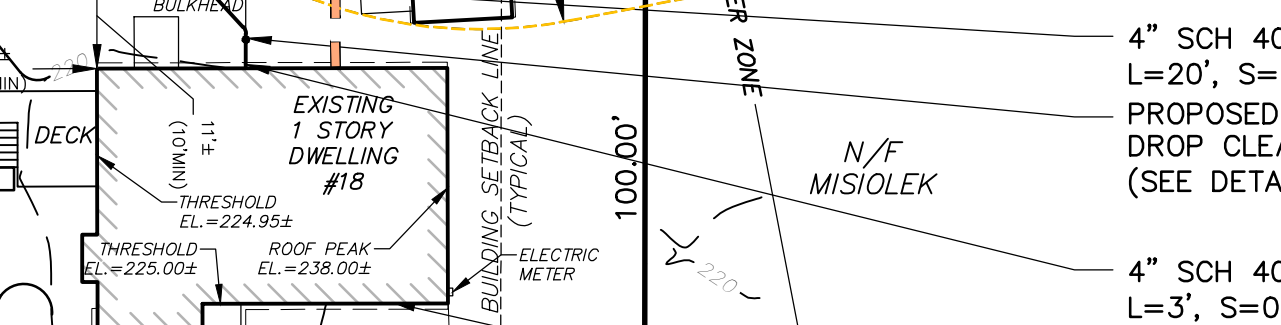

CLEANOUT DETAIL

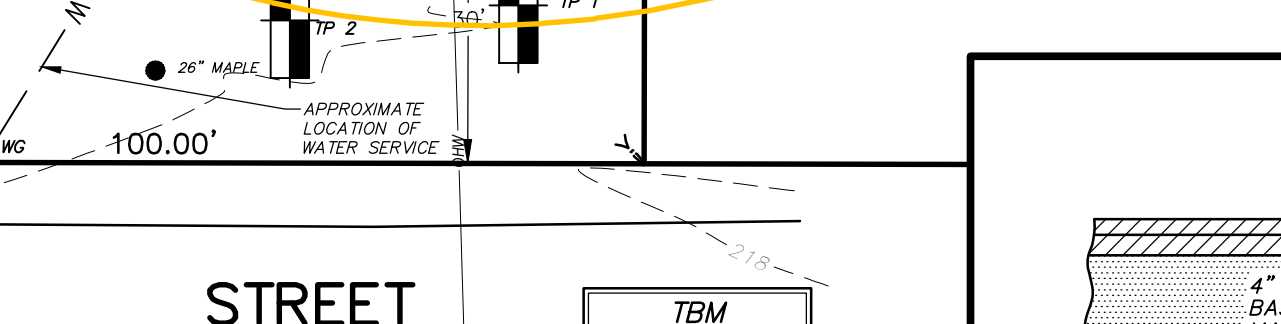

RAISED CONNECTION DETAIL

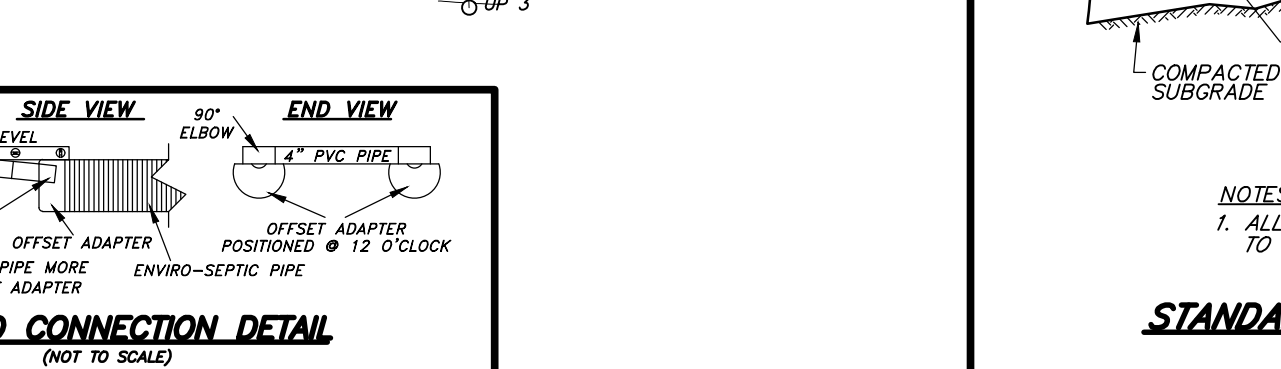

SEWAGE DISPOSAL PLAN

PREPARED FOR: PAUL DUDLEY
ADDRESS 18 PLEASANT STREET
LITTLETON, MA 01460
LOCATION: 18 PLEASANT STREET
PARCEL U39-23
LITTLETON, MA 01460
SCALE: AS SHOWN
DATE: JUNE 16, 2025
REVISED: JULY 3, 2025
PREPARED BY: STAMSKI AND McNARY, INC.
CIVIL ENGINEERS LAND SURVEYORS
1000 MAIN STREET - ACTON, MA 01720
(978) 263-8585
DESIGNED BY: MN DRAWN BY: MN JOB No. SM-7833 FILE: 7833.SDS.B.DWG