

CONCEPTUAL CONSTRUCTION SEQUENCING:

- = PHASE 1: INSTALL WASTEWATER TREATMENT FACILITY AND WASTEWATER DISPERSAL FIELD INCLUDING ASSOCIATED EROSION CONTROL, EARTHWORK, ACCESS, UTILITIES, AND STORM WATER MANAGEMENT. PERFORM REMOVAL AND RESTORATION OF DEBRIS PILE INCLUDING ASSOCIATED EROSION CONTROL AND ACCESS.

- = PHASE 2A: PREPARATION OF BUILDING PAD FOR BUILDING 1 (OR BUILDING 2 DEPENDING ON FUTURE TENANT) INCLUDING ASSOCIATED EROSION CONTROL, EARTHWORK, ACCESS, UTILITIES, AND STORM WATER MANAGEMENT.

- = PHASE 2B: PREPARATION OF BUILDING PAD FOR BUILDING 2 (OR BUILDING 1 DEPENDING ON FUTURE TENANT) INCLUDING ASSOCIATED EROSION CONTROL, EARTHWORK, ACCESS, UTILITIES, AND STORM WATER MANAGEMENT.

- = PHASE 3: PREPARATION OF BUILDING PAD FOR BUILDING 3 INCLUDING ASSOCIATED EROSION CONTROL, EARTHWORK, ACCESS, UTILITIES, AND STORM WATER MANAGEMENT. INSTALL FORCE MAIN AND WALKING TRAIL.

CONCEPTUAL CONSTRUCTION SEQUENCING FOR EACH PHASE:

1. MAINTAIN AND RELOCATE PERIMETER EROSION AND SEDIMENT CONTROL AND RELOCATE AS CONSTRUCTION PROGRESSES.
2. INSTALL TEMPORARY CONSTRUCTION ACCESS DRIVE WITH CONSTRUCTION ENTRANCE IN A MANNER TO MINIMIZE DISTURBANCE AND EARTHWORK ACTIVITIES.
3. INSTALL TEMPORARY SEDIMENT BASINS, DIVERSION SWALES, AND BERMS ASSOCIATED WITH CURRENT PHASE OF CONSTRUCTION. RELOCATE TEMPORARY MEASURES AS CONSTRUCTION PROGRESSES.
4. PERFORM TREE REMOVAL AND GRUB THE LIMIT OF WORK ASSOCIATED WITH CURRENT PHASE OF CONSTRUCTION ONLY.
5. EARTHWORK IS PRIMARY FILL. GRADE THE DISTURBED AREA TO ENCOURAGE RUNOFF TO FLOW TO LOW AREAS ALONG THE BASE OF THE EXISTING SLOPE, AWAY FROM WETLAND RESOURCE AREAS.
6. PERFORM DEWATERING WHERE REQUIRED TO PUMP DISCHARGE TO TEMPORARY SEDIMENT REMOVAL MEASURES IN UPLAND AREAS, AWAY FROM WETLAND RESOURCE AREAS.
7. STABILIZE CURRENT PHASE OF CONSTRUCTION IN ACCORDANCE WITH NOTES ON SHEET C-111 AND SWPPP DOCUMENT PRIOR TO ADVANCING TO NEXT PHASE.

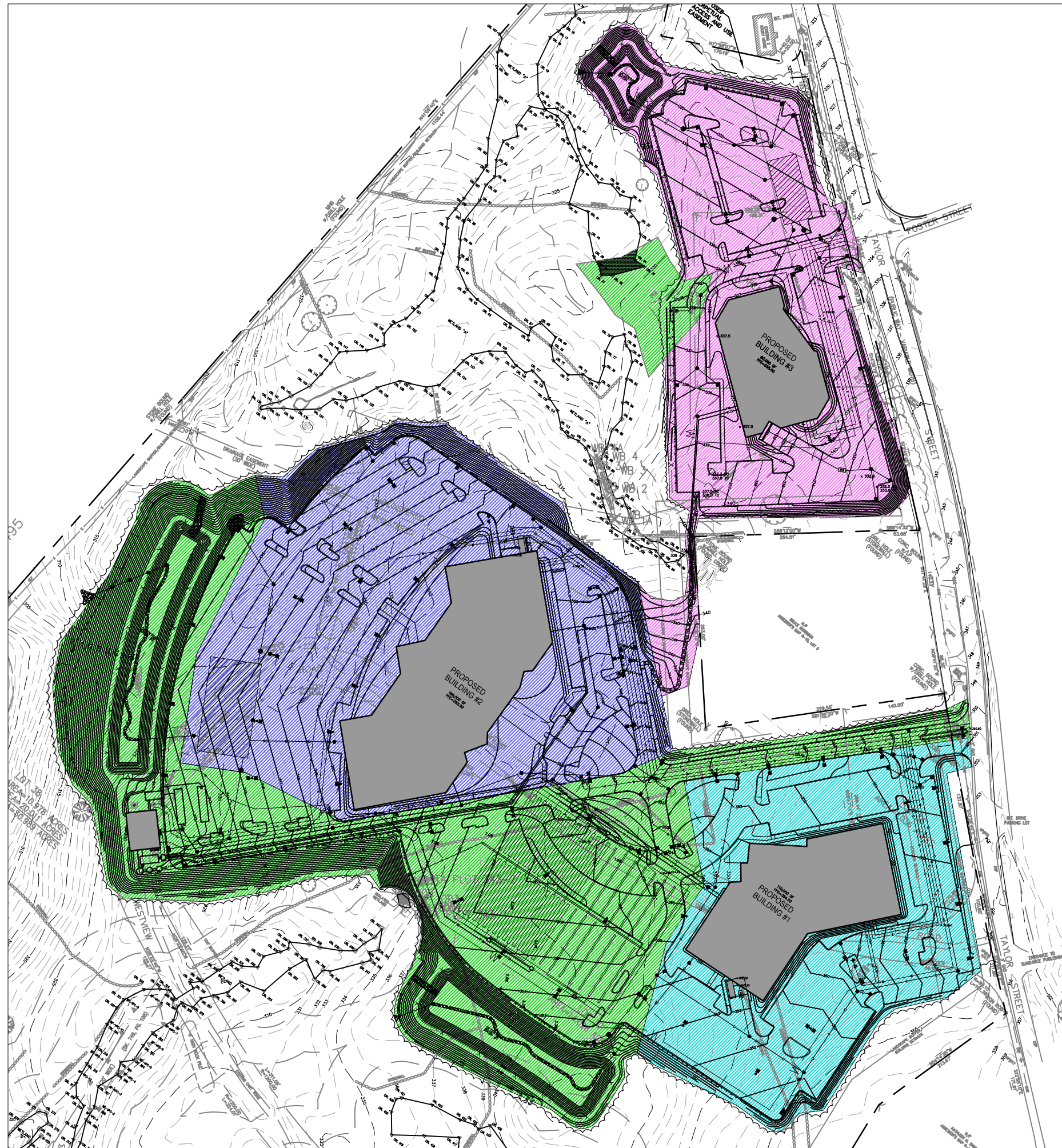
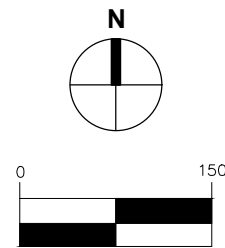

DATE:	01/03/2019
ISSUE:	
SCALE:	1" = 150'
REF:	WWP
DR BY:	MF
CK BY:	